



## VMAX2/Spectrum Vertical Limit Switch Adjustment Instructions

**Caution:** The screen's **Top Black Drop** is already set to its maximum drop distance. There is **NO** extra black top drop in the roller. Attempting to increase the drop will damage the motor and VOID your warranty with Elite Screens. Do not use these instructions to try and get more out of your standard black masking drop. Please contact Elite Screens before making any adjustments.

### 1. Allen Wrench



Fig. 1

5/32" Allen Wrench

### 2. Limit Adjustment Switches

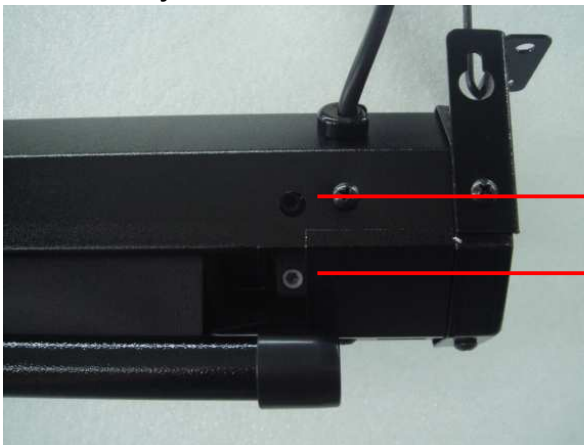

Fig. 2

UP adjustment switch

DOWN adjustment switch

(Note: When turning the limit switches, bear in mind that one full-circle turn in either direction will create a one inch adjustment)

3. Adjusting Retraction Position (shown in Fig. 3 – Fig. 7)



Fig. 3

If the screen will not retract completely (as shown in Fig. 3), use the following steps.



Fig. 4

Use remote to retract screen as much as possible.

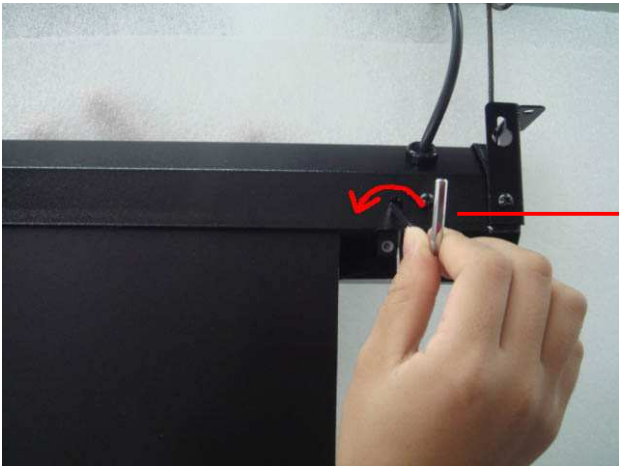

Fig. 5

Use your allen-wrench to turn the UP switch counter-clockwise.

**Note: Adjustment should be made while facing the back of the screen.**



Fig. 6

One full turn will retract your screen by 1". In order to see adjustment, deploy and retract the screen. (**Warning:** If you continue to rotate the switch once the weight bar fits flush with the casing, the screen will attempt to retract further, causing damage to the unit. DO NOT over turn the switch).



Fig. 7

If the screen retracts too far, just rotate the UP adjustment switch 2-3 turns clockwise, and the screen will lower.

**Note: Adjustment should be made while facing the back of the screen.**

#### 4. Adjusting the Top Black Masking (shown in Fig. 8 – Fig. 12)

**Note:** All electric screens come with standard top black masking and they cannot be dropped further. **DO NOT** use these instructions to try to get more out of your standard black masking drop.



Fig. 8

If you need to decrease the amount of top black masking, refer to the following steps.



Fig. 9

Use your remote to fully lower the screen.

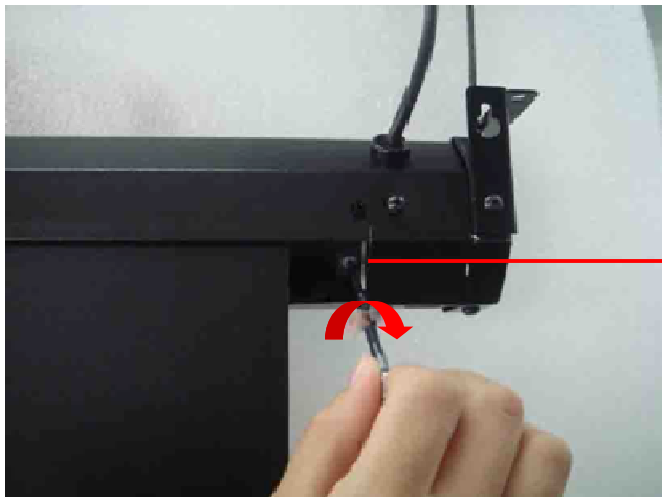

Fig. 10

Use your allen-wrench to turn the DOWN switch clockwise

**Note: Adjustment should be made while facing the back of the screen.**



Fig. 11

One full turn equals 1" of decreased drop. In order to notice the adjustment, retract and deploy the screen. Warning: Over adjusting the switch will damage the motor and void the warranty.

**Note: As a rule, Elite Screens does not recommend making unnecessary adjustments to the screen, as improper adjustments will damage the unit. Please contact Technical Support for assistance @ (877) 511-1211**